

OUTPUT TYPE

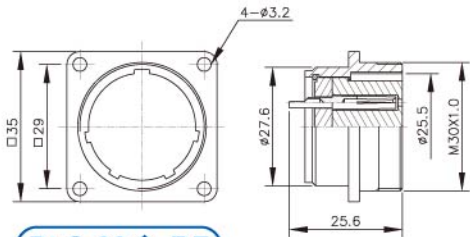

PLS-28-RF

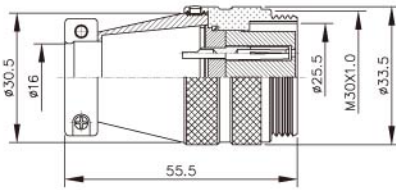

PLS-28-ADF

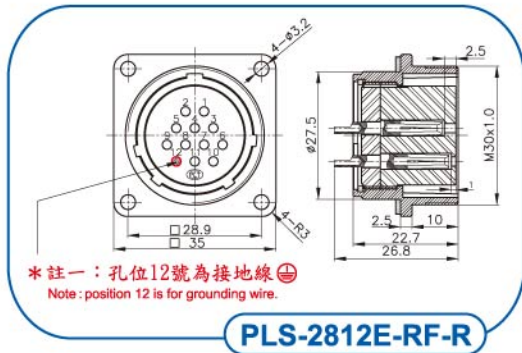

PLS-2812E-RF-R

ACCESSORY:

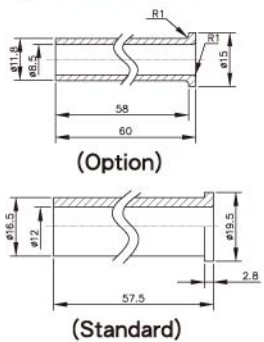

RUBBER PLATE FOR PLS-28-RF

RUBBER TUBE FOR PLS-28-PM

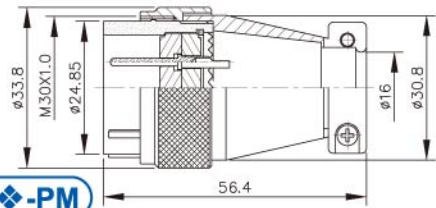

PLS-28-PM

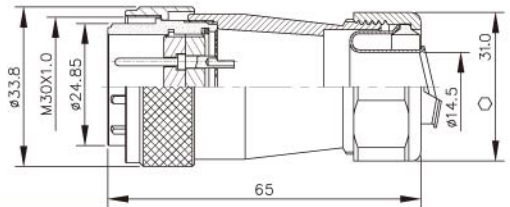

PLS-28-GPM4 4=轉接1/2"軟管

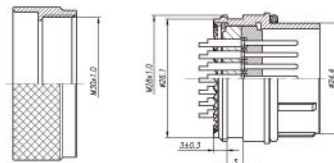

PLS-28-PMA XB-R

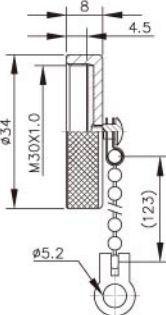

PLS-28-RCa-R



◆ No. of contacts	12	16	17	20	26		
Contacts Configuration							
Rated current / voltage	10A 250V	10A 250V	10A 250V	5A 250V	5A 250V		
Operation limit voltage (AC.V.rms)	250	250	250	250	250		
Withstanding voltage (AC.V.rms) 1 minute	1000	1000	1000	1000	1000		
Insulation resistance (MΩ MIN.) at DC 500V	1000	1000	1000	1000	1000		
Contact resistance (mΩ MAX.) at DC 1A	5	5	5	3	3		
Solder inter diameter	1.6	1.6	1.6	1.2	1.2		